



ROANOKE PARK STAIR AND OUTDOOR IMPROVEMENTS

10.10.2011
SCHEMATIC DEVELOPMENT PACKAGE

Hufft Projects

321 W. 40th St.
Kansas City, MO 64111
P // 816.531.0200
F // 816.531.0201

www.hufft.com

Make Studios

321 W. 40th St.
Kansas City, MO 64111
P // 816.531.0202
F // 816.531.0201

www.make-studios.com













1. Westport Roanoke Community Center
2. Roanoke Road
3. Valentine Road
4. W. 37th Street
5. Roanoke Park
6. Rock Outcropping
7. Gate to Community Center
8. Existing Utility Lines
9. Proposed Bench
10. Proposed Steps
11. Existing Tree as Focal Point
12. Existing Sidewalk
13. Pavers
14. Courtyard



- 1. Westport Roanoke Community Center
- 2. Roanoke Road
- 3. Valentine Road
- 4. W. 37th Street
- 5. Roanoke Park
- 6. Rock Outcropping
- 7. Gate to Community Center
- 8. Existing Utility Lines
- 9. Proposed Bench
- 10. Proposed Steps
- 11. Existing Tree as Focal Point
- 12. Existing Sidewalk
- 13. Pavers
- 14. Courtyard



- 1. Westport Roanoke Community Center
- 2. Roanoke Road
- 3. Valentine Road
- 4. W. 37th Street
- 5. Roanoke Park
- 6. Rock Outcropping
- 7. Gate to Community Center
- 8. Existing Utility Lines
- 9. Proposed Bench
- 10. Proposed Steps
- 11. Existing Tree as Focal Point
- 12. Existing Sidewalk
- 13. Pavers
- 14. Courtyard

- 1. Westport Roanoke Community Center
- 2. Roanoke Road
- 3. Valentine Road
- 4. W. 37th Street
- 5. Roanoke Park
- 6. Rock Outcropping
- 7. Gate to Community Center
- 8. Existing Utility Lines
- 9. Proposed Bench
- 10. Proposed Steps
- 11. Existing Tree as Focal Point
- 12. Existing Sidewalk
- 13. Pavers
- 14. Courtyard

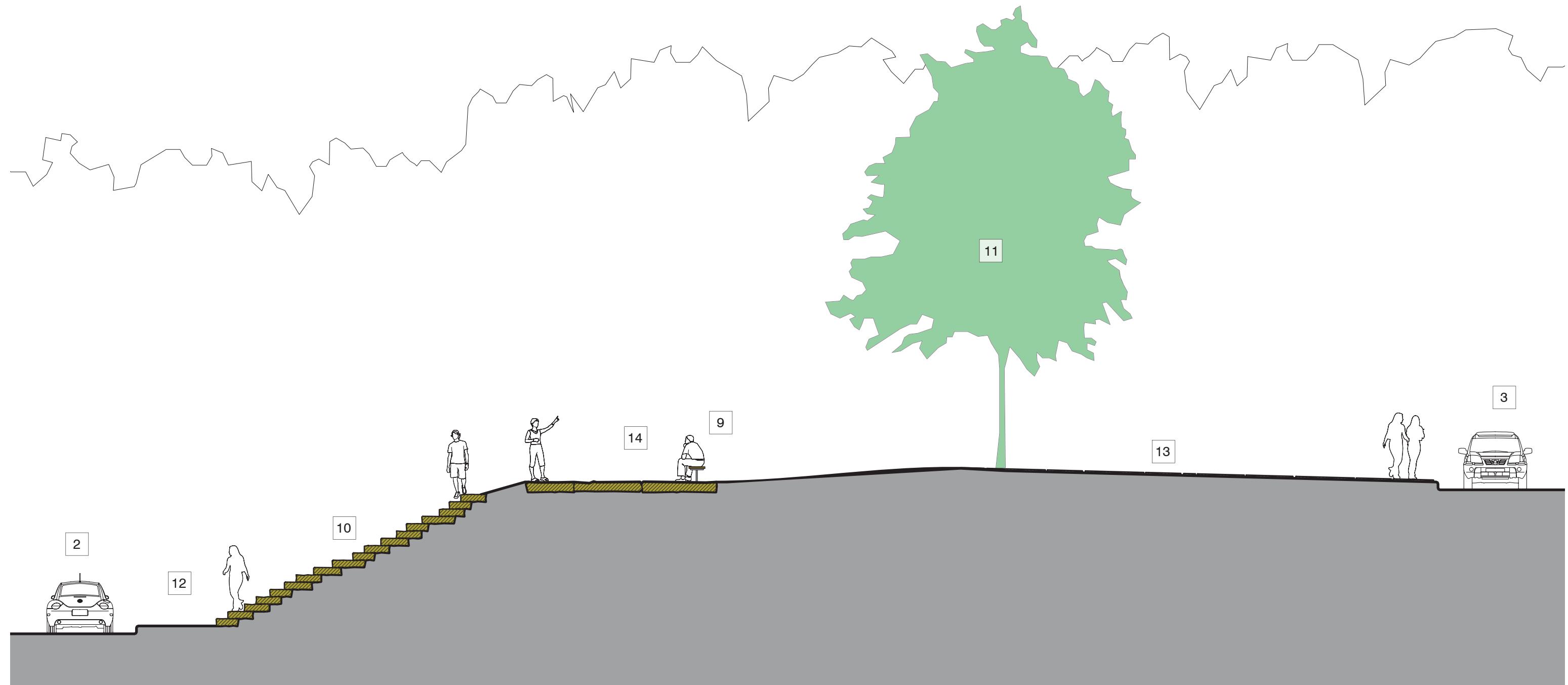

- 1. Westport Roanoke Community Center
- 2. Roanoke Road
- 3. Valentine Road
- 4. W. 37th Street
- 5. Roanoke Park
- 6. Rock Outcropping
- 7. Gate to Community Center
- 8. Existing Utility Lines
- 9. Proposed Bench
- 10. Proposed Steps
- 11. Existing Tree as Focal Point
- 12. Existing Sidewalk
- 13. Pavers
- 14. Courtyard

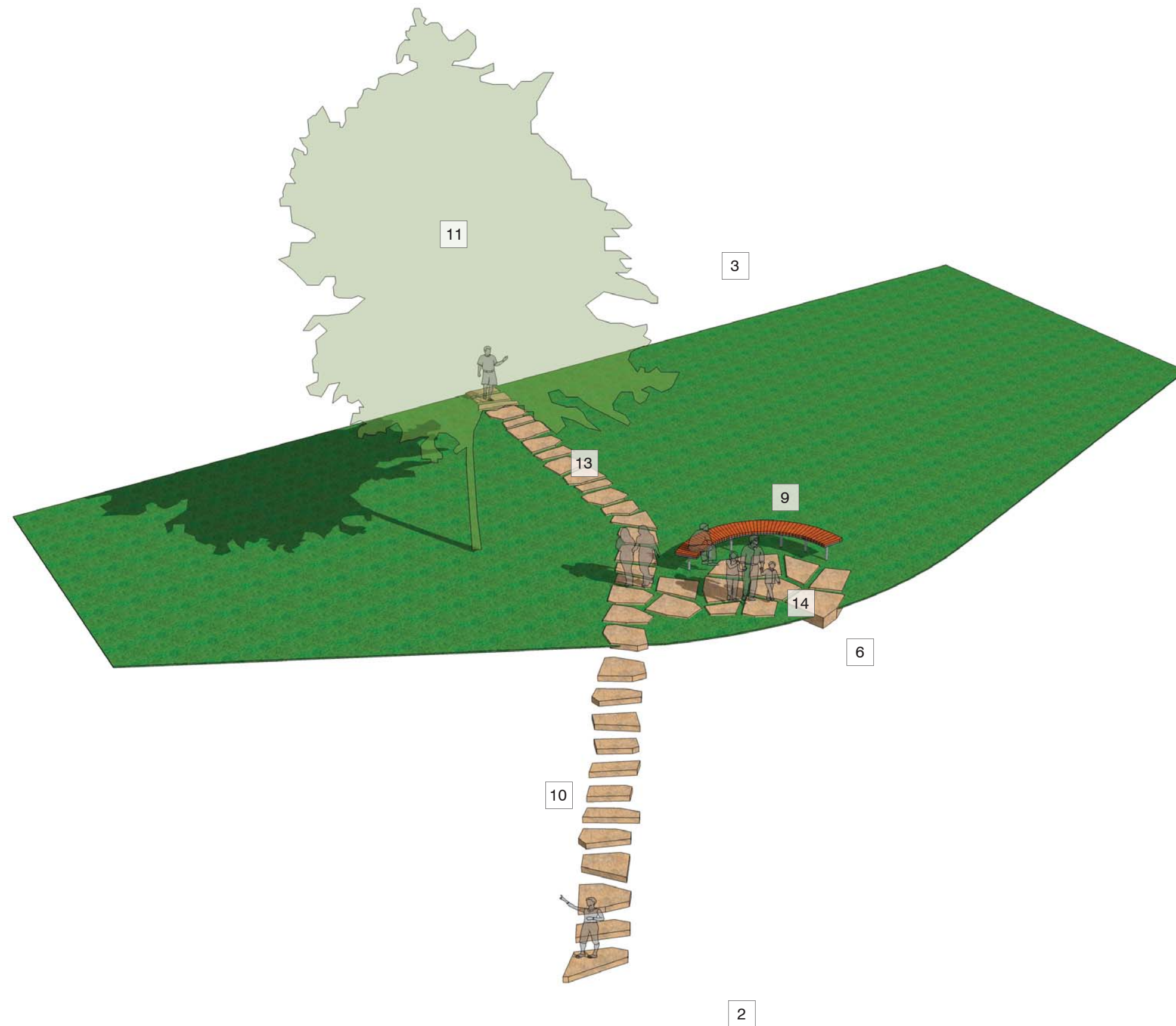

- 1. Westport Roanoke Community Center
- 2. Roanoke Road
- 3. Valentine Road
- 4. W. 37th Street
- 5. Roanoke Park
- 6. Rock Outcropping
- 7. Gate to Community Center
- 8. Existing Utility Lines
- 9. Proposed Bench
- 10. Proposed Steps
- 11. Existing Tree as Focal Point
- 12. Existing Sidewalk
- 13. Pavers
- 14. Courtyard

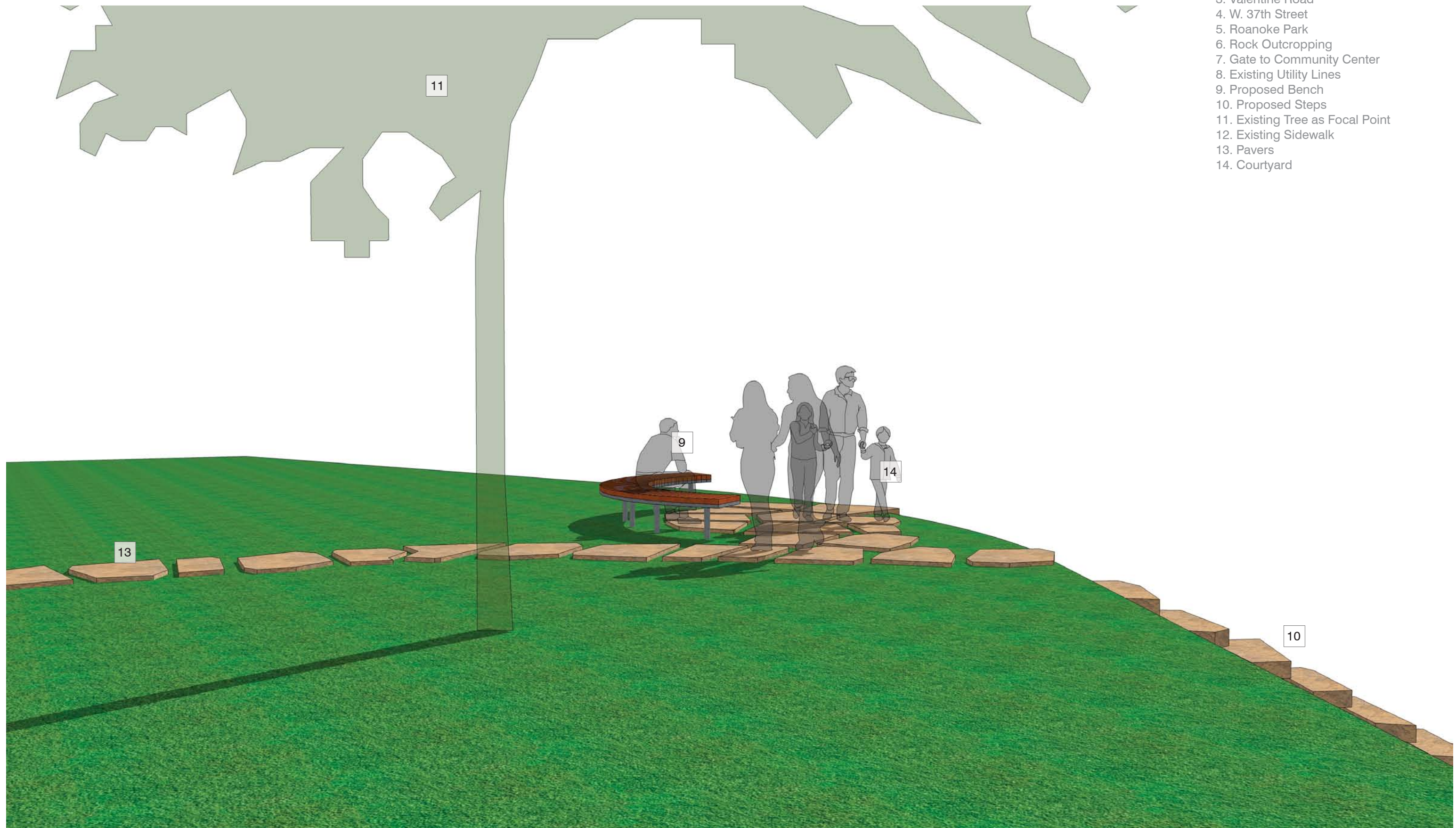

- 1. Westport Roanoke Community Center
- 2. Roanoke Road
- 3. Valentine Road
- 4. W. 37th Street
- 5. Roanoke Park
- 6. Rock Outcropping
- 7. Gate to Community Center
- 8. Existing Utility Lines
- 9. Proposed Bench
- 10. Proposed Steps
- 11. Existing Tree as Focal Point
- 12. Existing Sidewalk
- 13. Pavers
- 14. Courtyard

